

Reproduced from Ordnance Survey Supermap Data with the permission of The Controller of Her Majesty's Stationery Office. Crown Copyright - Licence No. AL100034021

Notes:

- Highway Boundary
- Shared Surface
- Tactile paving
- Area of low planting (less than 0.6m) for visibility splay
- Visibility Splay 2.4m X 43m
- Visibility Splay 2.4m X 25m
- Forward Visibility Splay 43m

Sources:

- Highway Boundary based on information provided by Hertfordshire County Council on 30 January 2020
- Survey Solutions drawing Topographical Survey Sheet 1-7 drawing number 24508cv-01-7 Rev A
- Site boundaries obtained from Hill drawing 2020-01-31_085702_2020-01-30-KDF-Site-Layout-Clean
- Based on Hill masterplan 108-PS-010 rev. H
- Based on TPA drawing 1908-012 PL06G

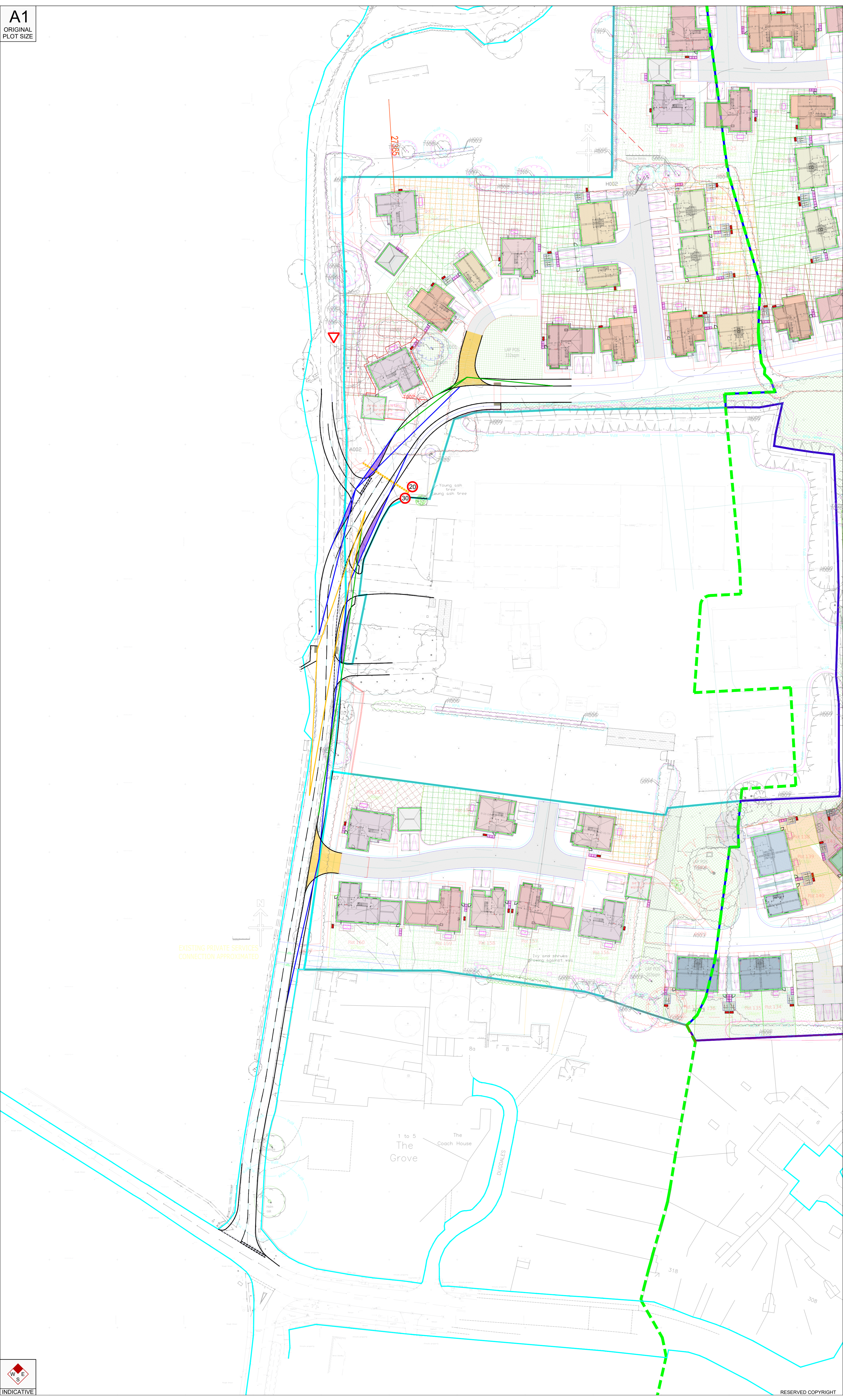

EXISTING PRIVATE SERVICES
CONNECTION APPROXIMATED

| Rev | Date | Details | Drawn By | Checked By | Approved By |
|-----|----------|---------------------|----------|------------|-------------|
| A | 22/02/21 | Revised site layout | SMK | DE | DE |

Bristol
Cambridge
London
Manchester
Oxford
Weylyn Garden City

tpa
Transport Planning Associates

90 High Holborn
London
WC1V 6LJ
020 7119 1155
www.tpa.uk.com

CLIENT:
HILL RESIDENTIAL LTD

PROJECT:
**KILLINGTON FARM,
LITTLE GREEN LANE,
RICKMANSWORTH**

TITLE:
**POTENTIAL LITTLE GREEN
LANE ALIGNMENT
VISIBILITY SPY**

STATUS:
PRELIMINARY

| SCALE: | DATE: | DRAWN: | CHECKED: | APPROVED: |
|----------|-------------|-----------|----------|-----------|
| 1:500 | 16/10/20 | SMK | DE | DE |
| JOB NO: | DRAWING NO: | REVISION: | | |
| 1908-012 | VS03 | A | | |

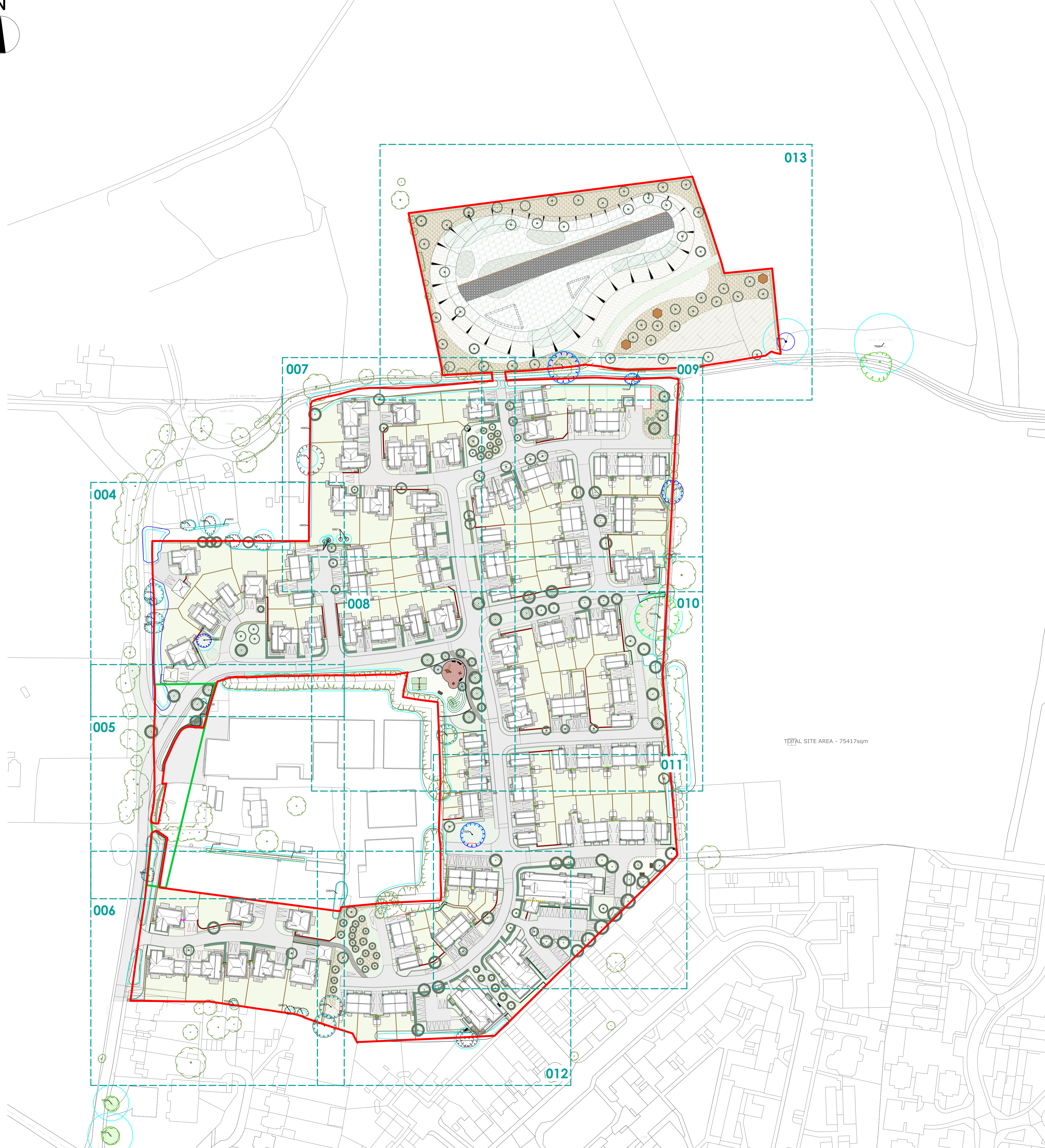
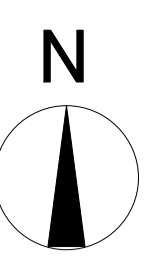

TOTAL SITE AREA - 75417sqm

Ecological and SUDS Area Key

- Native Hedge**
with biodegradable weed matting to base and rabbit guards.
- Native Buffer Mix**
Native whips to be pit planted into banks of eco area with rabbit guards.
- Native Attenuation Mix**
Native whips suitable for damp ground to be pit planting into bank of attenuation area.
- Wildflower Mix 1**
Mix of native wildflowers and grasses
- Wildflower Mix 2**
Seed mix of native wild flowers and grasses suitable for attenuation areas.
- Wildflower (Marginal) Mix 3**
Seed mix of native wild flowers and grasses suitable for sowing at the wet margins of ponds, streams and ditches.
- Wildflower (Hedgerow) Mix 4**
Seed mix of native wild flowers and grasses suitable for the variable shade conditions adjacent to hedges and beneath trees.

Boundary
1m high stock/forest fence with timber posts and wire mesh.

- ### Ecological Features
- Deadwood Piles**
To be made up from felled sections of trees from the existing orchard on site to be removed. Size and construction to ecologist's recommendations.

- Planning application boundary**
- Access works boundary**

- ### Softworks Key
- Indicative position of existing trees**
Refer to Arboricultural Impact Assessment by Hayden's Arboricultural consultants
 - Proposed feather tree (FTH)**
with single diagonal stake and tie to specification
 - Proposed standard tree (S/SS)**
with double stake and tie (refer to Inset 1)
 - Proposed heavy standard tree (HS)**
with double stake and tie (refer to Inset 1)
 - Proposed extra heavy standard tree (EHS)**
with double stake and tie (refer to Inset 1)
 - Ornamental Planting Bed**
with 75mm depth bark mulch to specification
 - Ornamental Hedge**
with 75mm depth bark mulch to specification
 - Native Hedge**
with 75mm depth bark mulch to specification
 - Native Buffer Mix**
with 75mm depth bark mulch to specification
 - Turf lawn to front gardens**
 - Grass within backgardens to be seeded.**
 - Seeded Amenity Grass**
within and surrounding LEAP to support informal play
 - Seeded Biodiverse Amenity Grass**
Mix of amenity grass with low growing wildflowers to improve diversity of sward while also supporting recreational use
 - Species Rich Lawn Turf**
within open space areas
 - Wildflower Mix 1**
Mix of native wildflowers and grasses
 - Wildflower (Existing)**
Within RPA of existing oak tree on eastern boundary, to be maintained as tussock grassland.
 - Wildflower (Hedgerow) Mix 4**
Seed mix of native wild flowers and grasses suitable for the variable shade conditions adjacent to hedges and beneath trees.
 - Native Bulb Mix**
Refer to schedule for species mix.

- ### Boundary Key
- ROSPA approved timber playtime fence**
1.01m high, 75mm pale spacing, planned finish, natural colour, matching gates
 - 5 bar post and rail fence**
1.2m high, with dog-proof galvanised mesh
 - Knee Rail**
0.9m high diamond timber knee rail.
 - Closeboard fence**
1.8m high to developer's specification.
 - Screen wall**
1.8m high brick wall
 - 4 rail post and rail fence**
1.5m high with mortised and tenoned rail and post joints.

Hardworks Key

- Main Roads & Pedestrian Pavements**
Vehicular macadam to engineer's specification with standard concrete kerbs and 50mm PCC edge to back of footway.
- Block paved roads**
Concrete block paving. Pattern: Herringbone. Size: 200x100mm. Single course edge, Colour: see below:
- Block paved roads - Autumn Gold**
- Block paved roads - Burnt Oak**
- Block paved roads - Charcoal**
- Private driveways**
Permeable concrete block paving. Pattern: Stretcher. Size: 215 x 115mm. Single course edge of the same colour:
- Private driveways - Autumn Gold**
- Private driveways - Burnt Oak**
- Private driveways**
Permeable concrete block paving. Pattern: Stretcher (AF2). Sizes: 140x140mm, 105x140mm, 210x140mm. Single course edge of the same colour:
- Private driveways - Autumn Gold**
- Private driveways - Burnt Oak**
- Private parking courts**
Permeable concrete block paving. Pattern: Herringbone. Size: 215x115mm. Colour: Autumn Gold, Single course edge of Burnt Oak to delineate parking bays and paths.
- Flag paved private patios within rear gardens and access paths**
Textured concrete paving. Pattern: Square. Colour: 'Buff'. Size: 450x450mm.
- Resin Bonded Rubber Mulch Safety Surface**
To be fully tested to EN1177 (2008) and required depth for critical fall height to play manufacturer's specification. Colour: Earth Brown.

- ### Furniture Key
- Litter bin**
 - Play area signage**
90cm x 60cm with timber legs
 - Timber benches with back and arm rests**
Hardwood slats, baseplated, galvanised frame
 - Timber picnic benches**
Treated softwood
 - Timber bollards**
150 x 150 x 900 sq mm, hardwood, pointed top. As required, to be removable for maintenance/emergency access: stainless steel socket with lock.
 - Indicative locations of lighting columns**
Refer to Lighting Strategy by Designs for Lighting for further information.

| | | | | |
|-----|----------|--------------------|----|----|
| 7 | 14/04/21 | Revised to layout. | RM | CX |
| Rev | Date | Comments | | Dr |



Stapleford Farm, Alphonstone, Bures, Essex, CO8 5DT
The Record Hill, 1 & 1A Baldwin's Gardens, Hatton Garden, London, EC1N 7RJ
+44 (0)1206 638085 - www.guardalandscape.com

Client
Hill Residential Limited
Site
Killingdown, Croxley Green

Drawing Title
Landscape Masterplan

| | | | |
|--------------------|------------|----------|-----------|
| Scale | 1:200 @ A1 | Status | Planning |
| Project | 1945 | Revision | 7 |
| Drawn | RM | Checked | CX |
| Date | | | June 2020 |
| © GUARDA Ltd. 2020 | | | |

THESE DRAWINGS ARE FOR PLANNING ONLY Contractor must verify all dimensions, levels and existing service alignments on site before commencing any work or shop drawings. Any discrepancy concerning the drawings/quantities should be referred to the Landscape Architect immediately. Do not scale off this drawing. All landscape drawings to be read in conjunction with the landscape specification and all relevant engineer's and architect's drawings/specifications. This drawing is Copyright and must not be reproduced without consent of Guarda Landscape.

ECOLOGICAL MITIGATION
Refer to Ecological Impact Assessment by Mike Dean Ecology for ecological mitigation and compensation measures.

A1
ORIGINAL
PLOT SIZE

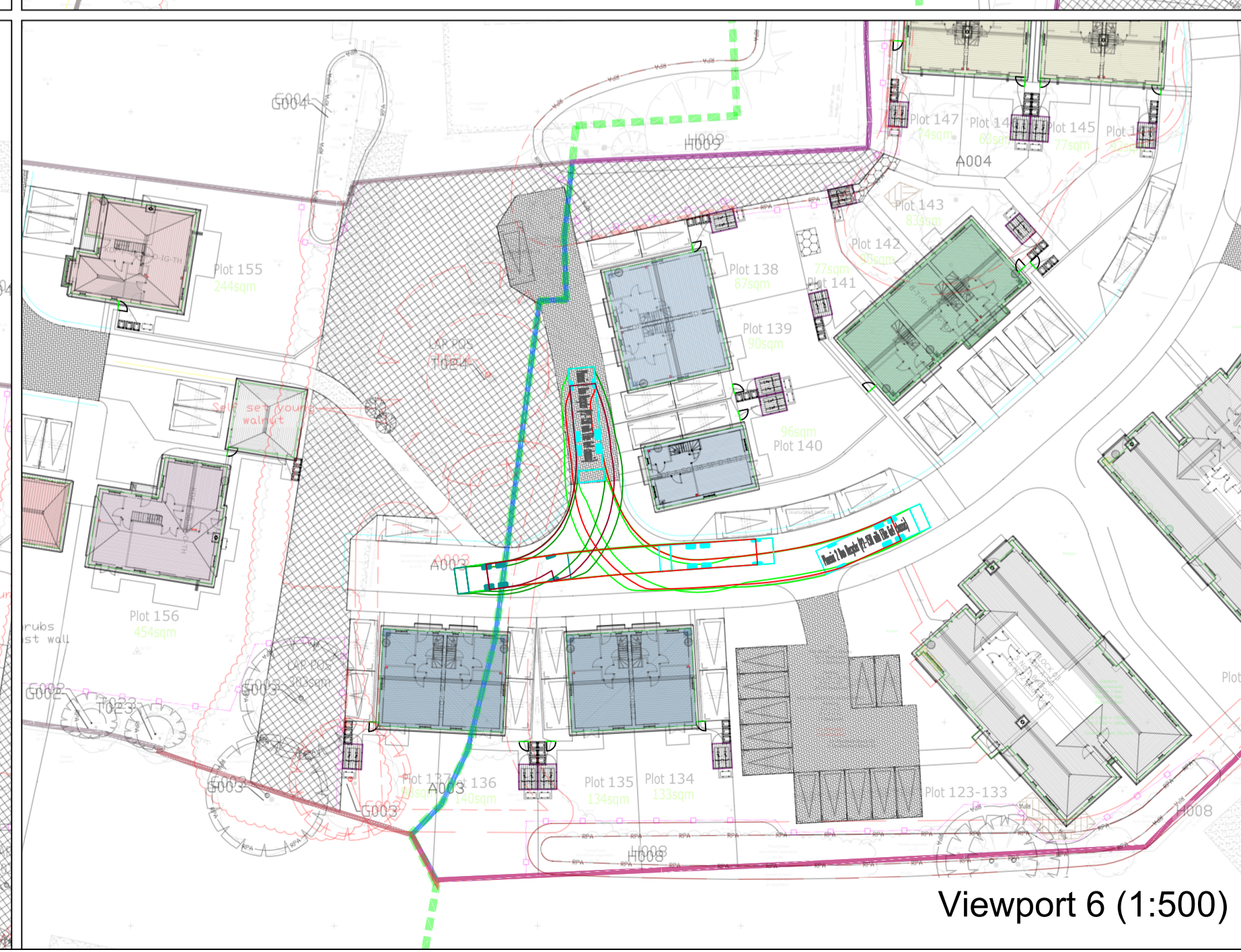
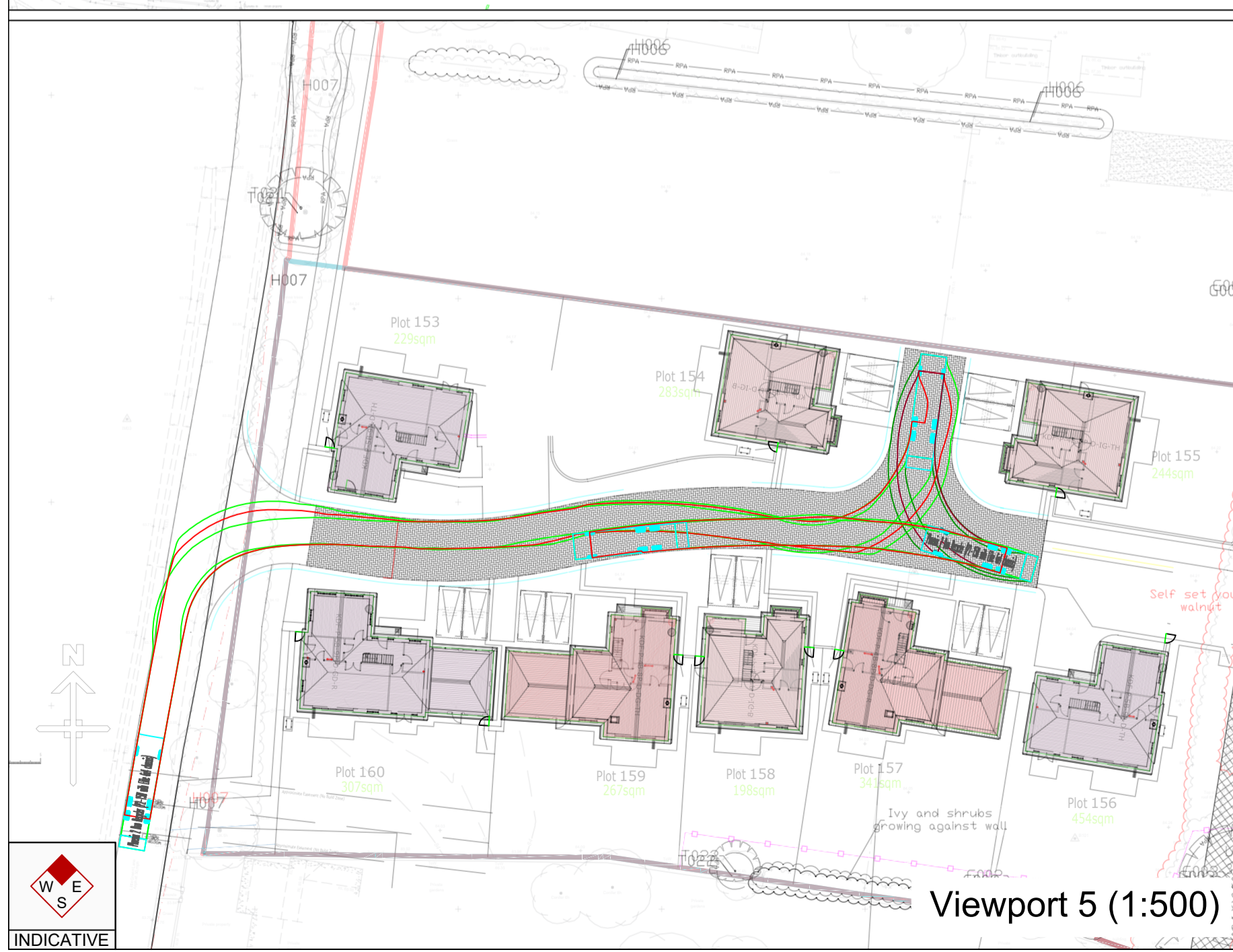
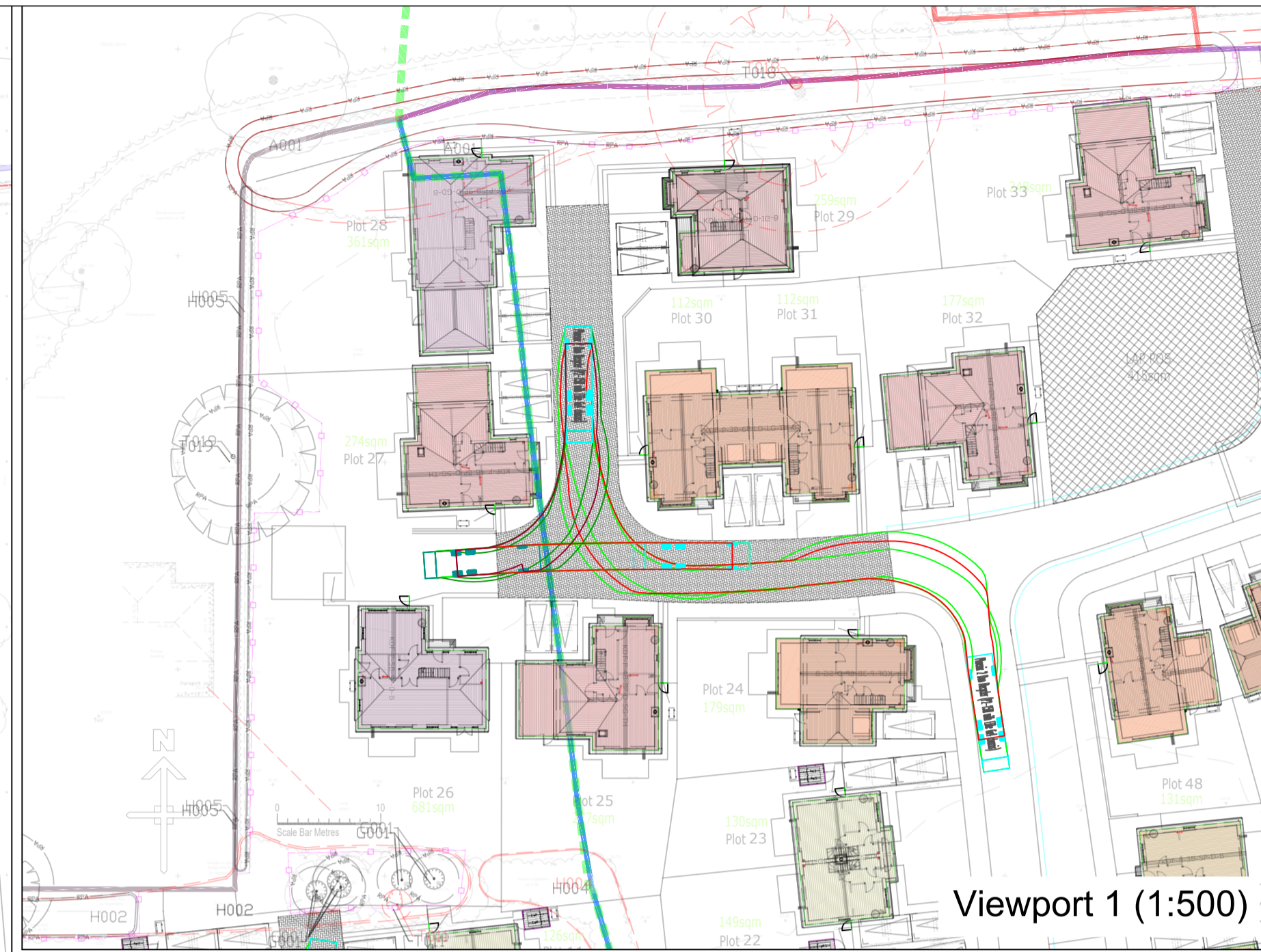
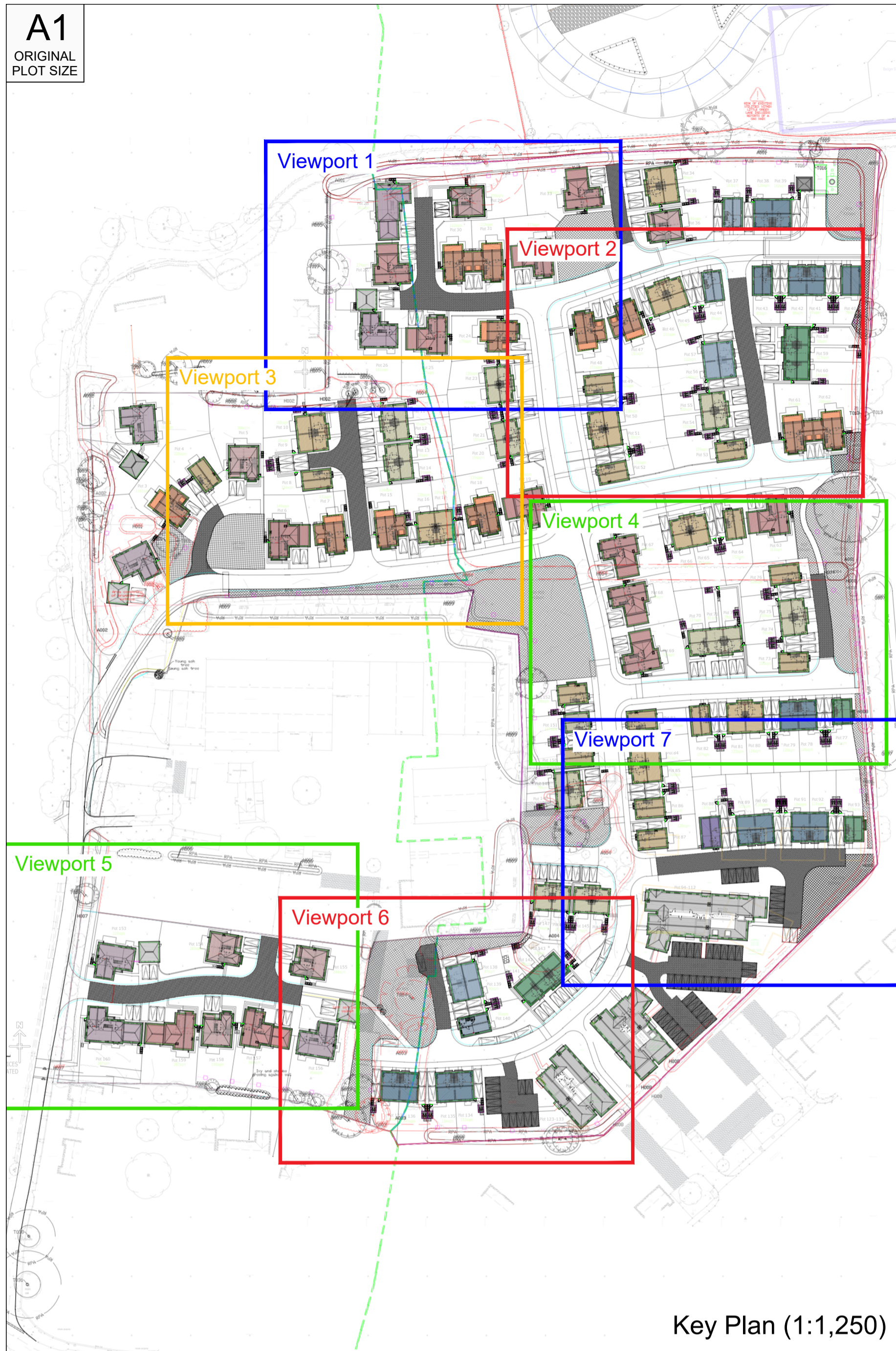

Reproduced from Ordnance Survey Superplan Data with the permission of The Controller of Her Majesty's Stationery Office. Crown Copyright. Licence No. AL10004021

NOTES:
Based on Hill drawing number 108-PS-010 revision H

Phoenix 2 Duo Recycler (P2-15W with Elite 6x4 chassis)
Overall Length 11.22m
Overall Width 3.00m
Overall Body Height 2.75m
Min Body Ground Clearance 0.250m
Track Width 2.50m
Load to Lock time 4.00m
Kerb to Kerb Turning Radius 11.550m

| | | | | | |
|-----|--------|---------------------|---------|----|----------|
| B | 120422 | Revised site layout | SMK | DE | DE |
| A | 180523 | Revised site layout | SMK | DE | DE |
| Rev | Date | Drawn | Checked | By | Approved |
| | | | | | |

Client:
HILL RESIDENTIAL LTD

Project:
**KILLINGTON FARM,
LITTLE GREEN LANE,
RICKMANSWORTH**

Title:
**SWEPT PATH ANALYSIS OF
THE PROPOSED TURNING
FACILITIES**

Status:
FOR INFORMATION

| | | | | |
|-----------|-------------|-----------|----------|-----------|
| SCALE: | DATE: | DRAWN: | CHECKED: | APPROVED: |
| AS STATED | 11/06/20 | SMK | DE | DE |
| JOB NO: | DRAWING NO: | REVISION: | | |
| 1908-012 | SP03 | B | | |

