

# Leavesden Country Park

Site description

East Lane Cemetery

## Legend

- Car park
- Hard surfaced path
- Scrub
- Woodland
- Site boundary
- Interpretation sign
- Historical feature
- Bench

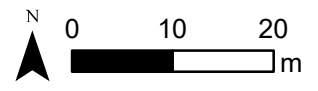

Scale @ A3  
1:750  
Date  
October 2020  
Rev  
00



© Crown copyright and database rights 2020 OS EUL 100019606. Use of this data is subject to terms and conditions. You are permitted to use this data solely to enable you to respond to, or interact with, the organisation that provided you with the data. You are not permitted to copy, sub-licence, distribute or sell any of this data to third parties in any form.

# Leavesden Country Park

## Site description

### Leavesden Country Park North

#### Legend

- Amenity grass
- Building
- Car park
- HIVE
- Hard surfaced path
- Hedgerow
- Orchard
- Ornamental beds
- Play area
- Rough grassland
- Scrub
- Sensory garden
- Sports facility
- Wildflower area
- Woodland
- Site boundary
- Bench
- Cycle rack
- Dog bin
- Entrance sign
- Finger post
- Historical feature
- Interpretation sign
- Kissing gate
- Litter bin
- Notice board
- Picnic table
- Sculptures
- Parkland tree



Scale @ A3  
1:2,400

Date  
October 2020

Rev  
00

© Crown copyright and database rights 2020 OS EUL 100019606. Use of this data is subject to terms and conditions. You are permitted to use this data solely to enable you to respond to, or interact with, the organisation that provided you with the data. You are not permitted to copy, sub-licence, distribute or sell any of this data to third parties in any form.

# Leavesden Country Park

## Site description

### Leavesden Country Park South

#### Legend

- Site boundary
- Amenity grass
- Car park
- Conservation grassland
- Hard surfaced path
- Hedgerow
- Mown grass path
- Orchard
- Ornamental beds
- Play area
- Rough grassland
- Scrub
- Wildflower area
- Woodland
- Bench
- Dog bin
- Entrance sign
- Finger post
- Historical feature
- Interpretation sign
- Kissing gate
- Litter bin
- Picnic table
- Sculptures
- Parkland tree
- Underground Power Line

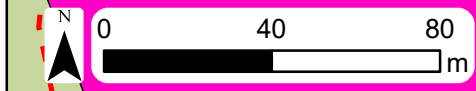

Scale @ A3  
1:1,800

Date  
October 2020

Rev  
00

© Crown copyright and database rights 2020 OS EUL 100019606. Use of this data is subject to terms and conditions. You are permitted to use this data solely to enable you to respond to, or interact with, the organisation that provided you with the data. You are not permitted to copy, sub-licence, distribute or sell any of this data to third parties in any form.

**Leavesden Country Park**  
 Site description  
 The Horses' Field

**Legend**

- Site boundary
- Amenity grass
- Conservation grassland
- Hard surfaced path
- Hedgerow
- Mown grass path
- Ornamental beds
- Play area
- Scrub
- Wildflower area
- Woodland
- Bench
- Dog bin
- Entrance sign
- Finger post
- Interpretation sign
- Kissing gate
- Litter bin
- Picnic table
- Vehicle entrance
- Sculptures
- Parkland tree
- Underground Power Line

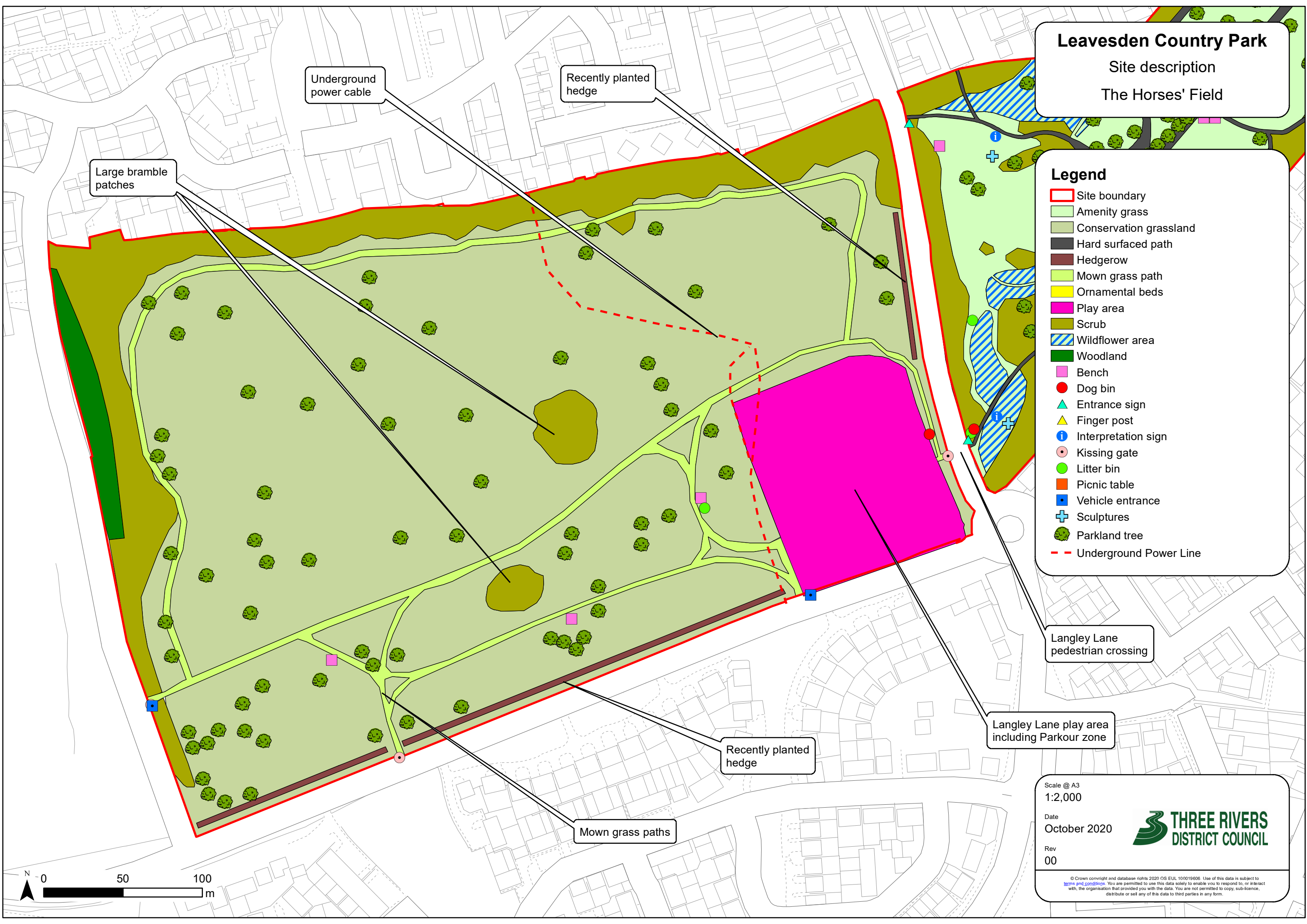

Large bramble patches

Underground power cable

Recently planted hedge

Langley Lane pedestrian crossing

Langley Lane play area including Parkour zone

Recently planted hedge

Mown grass paths

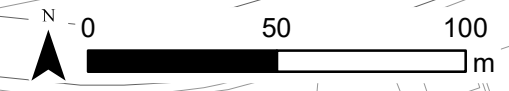

Scale @ A3  
 1:2,000

Date  
 October 2020

Rev  
 00



© Crown copyright and database rights 2020 OS EUL 100019606. Use of this data is subject to terms and conditions. You are permitted to use this data solely to enable you to respond to, or interact with, the organisation that provided you with the data. You are not permitted to copy, sub-licence, distribute or sell any of this data to third parties in any form.

# Leavesden Country Park Management and Maintenance Plan East Lane Cemetery

- Task responsibility**
- TRDC Environmental Protection
  - TRDC Landscape & Leisure
  - TRDC Other
  - Volunteers
  - HCC/CMS

- Legend**
- Car park
  - Hard surfaced path
  - Scrub
  - Woodland
  - Site boundary
  - i Interpretation sign
  - Historical feature
  - Bench

- Site wide works**
- Tree safety survey every 2-3 years, with annual check □ □
  - General tree safety management □
  - Check and reduce epicormic growth - twice annually □
  - Voluntary work by Leavesden Hospital History Association and Friends of Leavesden Country Park □
  - Paint lamp posts and directional signage - biannually □
  - Sand and paint benches and totem pole - biannually □ □
  - Inspect, clean and maintain street furniture □
  - Maintain natural perimeter to park for wildlife □
  - Maintain 0.5m long grass around all trees □
  - Inspect, clean and maintain all signage, including interpretation panels, maps, welcome signs □

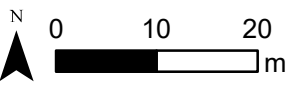
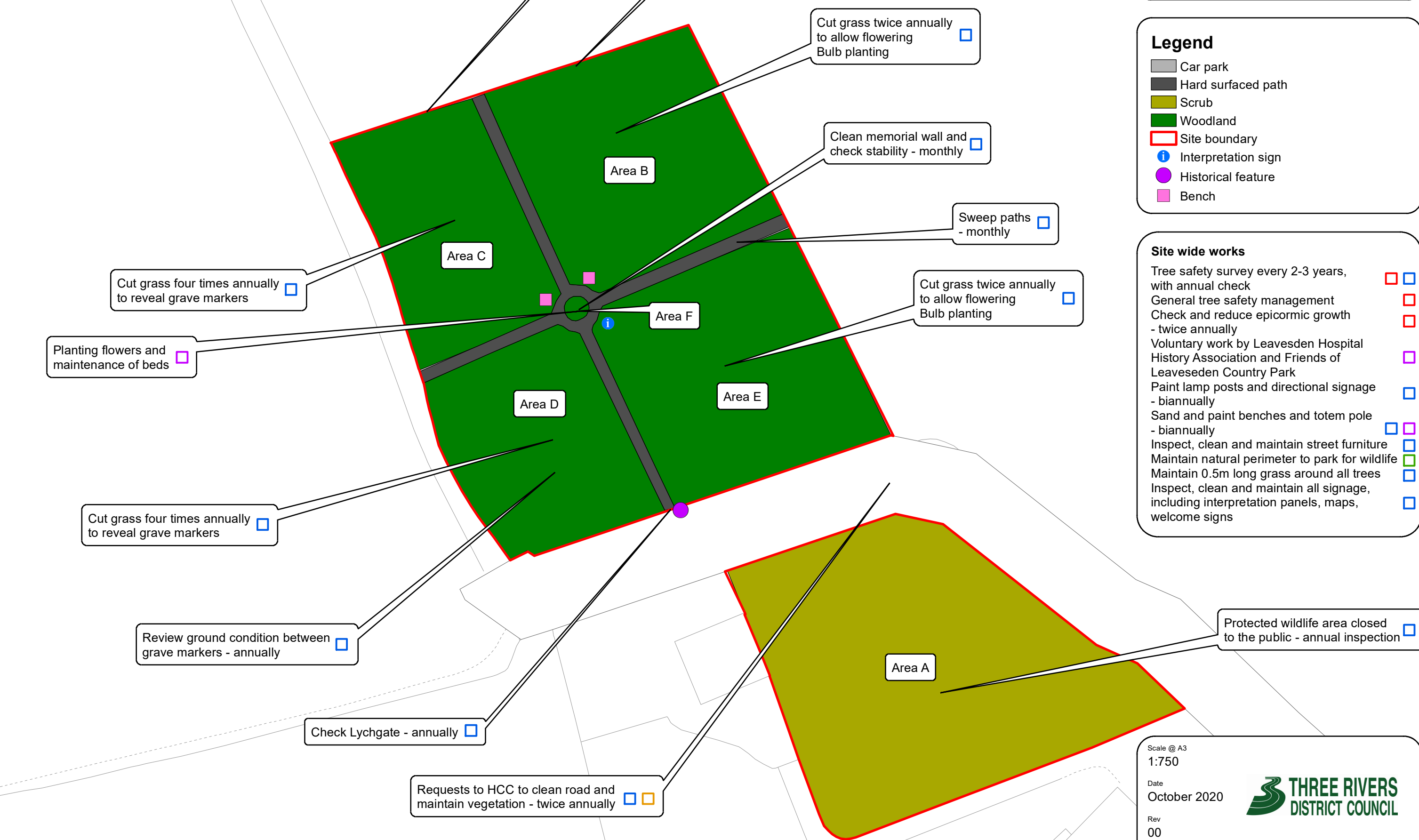

Scale @ A3  
1:750

Date  
October 2020

Rev  
00

© Crown copyright and database rights 2020 OS EUL 100019606. Use of this data is subject to terms and conditions. You are permitted to use this data solely to enable you to respond to, or interact with, the organisation that provided you with the data. You are not permitted to copy, sub-licence, distribute or sell any of this data to third parties in any form.

# Leavesden Country Park Management and Maintenance Plan Leavesden Country Park North

- Task responsibility**
- TRDC Environmental Protection
  - TRDC Landscape & Leisure
  - TRDC Other
  - Volunteers
  - HCC/CMS

- Legend**
- Site boundary
  - Amenity grass
  - Building
  - Car park
  - HIVE
  - Hard surfaced path
  - Hedgerow
  - Orchard
  - Ornamental beds
  - Play area
  - Rough grassland
  - Scrub
  - Sensory garden
  - Sports facility
  - Wildflower area
  - Woodland
  - Bench
  - Cycle rack
  - Dog bin
  - ▲ Entrance sign
  - ▲ Finger post
  - Historical feature
  - i Interpretation sign
  - Kissing gate
  - Litter bin
  - i Notice board
  - Picnic table
  - + Sculptures
  - Parkland tree

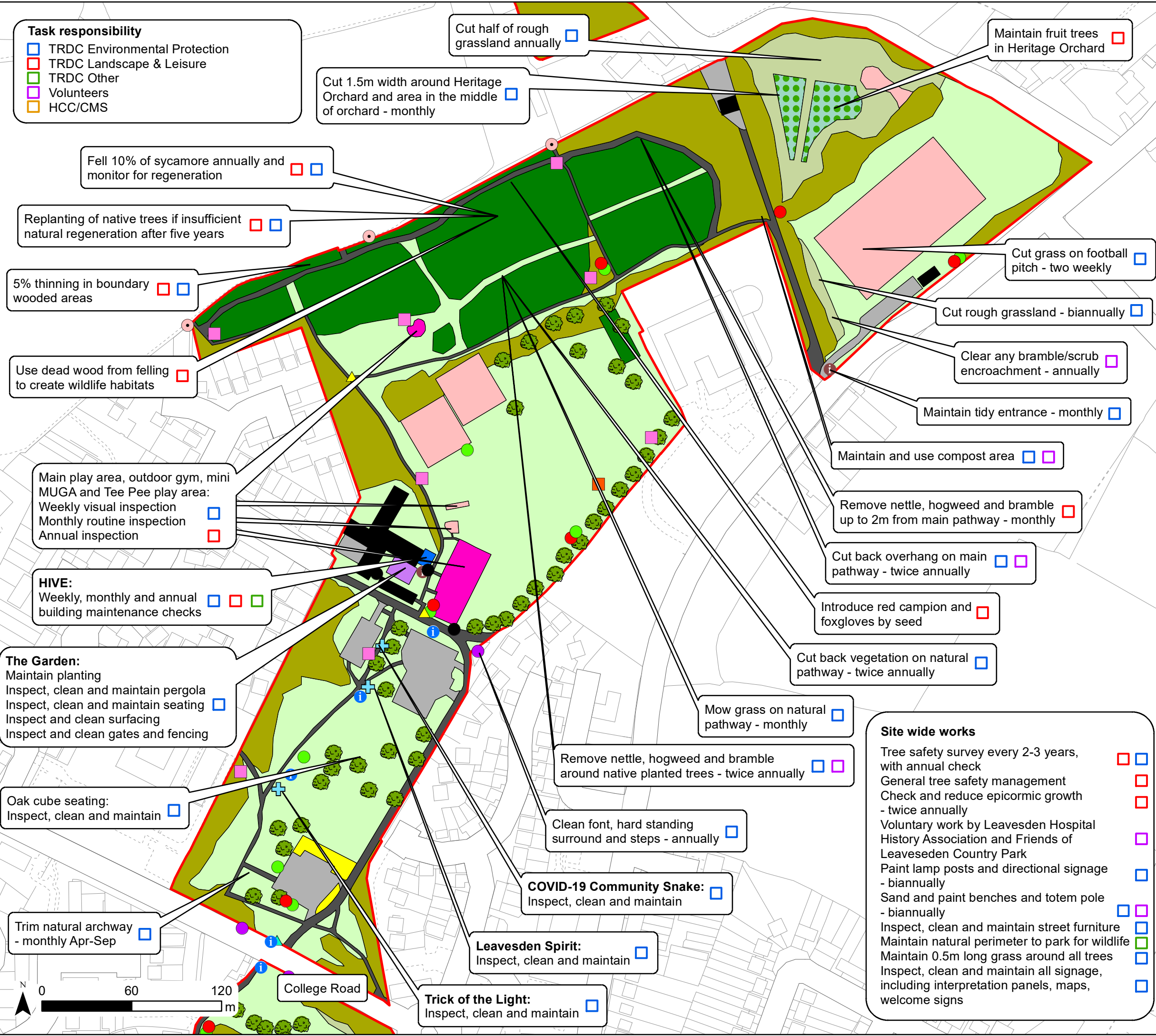

Cut grass on football pitch - two weekly □

Cut rough grassland - biannually □

Clear any bramble/scrub encroachment - annually □

Maintain tidy entrance - monthly □

Maintain and use compost area □ □

Remove nettle, hogweed and bramble up to 2m from main pathway - monthly □

Cut back overhang on main pathway - twice annually □ □

Introduce red campion and foxgloves by seed □

Cut back vegetation on natural pathway - twice annually □

Mow grass on natural pathway - monthly □

Remove nettle, hogweed and bramble around native planted trees - twice annually □ □

Clean font, hard standing surround and steps - annually □

**COVID-19 Community Snake:**  
Inspect, clean and maintain □

**Leavesden Spirit:**  
Inspect, clean and maintain □

**Trick of the Light:**  
Inspect, clean and maintain □

Maintain fruit trees in Heritage Orchard □

Cut 1.5m width around Heritage Orchard and area in the middle of orchard - monthly □

Cut half of rough grassland annually □

Fell 10% of sycamore annually and monitor for regeneration □ □

Replanting of native trees if insufficient natural regeneration after five years □ □

5% thinning in boundary wooded areas □ □

Use dead wood from felling to create wildlife habitats □

Main play area, outdoor gym, mini MUGA and Tee Pee play area:  
Weekly visual inspection □  
Monthly routine inspection □  
Annual inspection □

**HIVE:**  
Weekly, monthly and annual building maintenance checks □ □ □

**The Garden:**  
Maintain planting  
Inspect, clean and maintain pergola □  
Inspect, clean and maintain seating □  
Inspect and clean surfacing  
Inspect and clean gates and fencing

Oak cube seating:  
Inspect, clean and maintain □

Trim natural archway - monthly Apr-Sep □

- Site wide works**
- Tree safety survey every 2-3 years, with annual check □ □
  - General tree safety management □
  - Check and reduce epicormic growth - twice annually □
  - Voluntary work by Leavesden Hospital History Association and Friends of Leavesden Country Park □
  - Paint lamp posts and directional signage - biannually □
  - Sand and paint benches and totem pole - biannually □ □
  - Inspect, clean and maintain street furniture □ □
  - Maintain natural perimeter to park for wildlife □
  - Maintain 0.5m long grass around all trees □
  - Inspect, clean and maintain all signage, including interpretation panels, maps, welcome signs □

Scale @ A3  
1:2,400

Date  
October 2020

Rev  
00



© Crown copyright and database rights 2020 OS EUL 100019606. Use of this data is subject to terms and conditions. You are permitted to use this data solely to enable you to respond to, or interact with, the organisation that provided you with the data. You are not permitted to copy, sub-licence, distribute or sell any of this data to third parties in any form.



College Road

# Leavesden Country Park Management and Maintenance Plan Leavesden Country Park South

- Task responsibility**
- TRDC Environmental Protection
  - TRDC Landscape & Leisure
  - TRDC Other
  - Volunteers
  - HCC/CMS

- Legend**
- Site boundary
  - Amenity grass
  - Car park
  - Conservation grassland
  - Hard surfaced path
  - Hedgerow
  - Mown grass path
  - Orchard
  - Ornamental beds
  - Play area
  - Rough grassland
  - Scrub
  - Wildflower area
  - Woodland
  - Bench
  - Dog bin
  - ▲ Entrance sign
  - ▲ Finger post
  - Historical feature
  - i Interpretation sign
  - Kissing gate
  - Litter bin
  - Picnic table
  - + Sculptures
  - Parkland tree
  - Underground Power Line

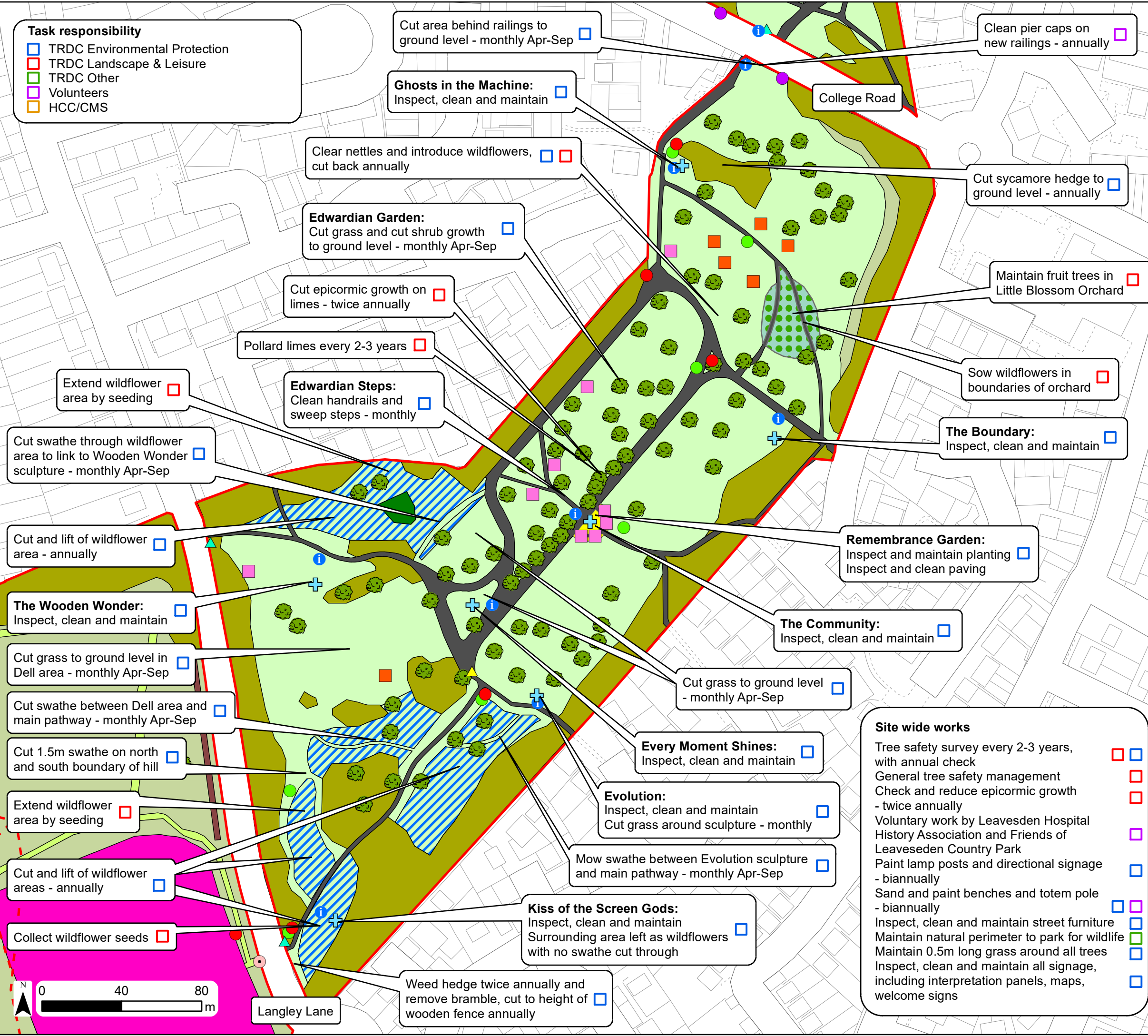

- Site wide works**
- Tree safety survey every 2-3 years, with annual check □ □
  - General tree safety management □ □
  - Check and reduce epicormic growth - twice annually □ □
  - Voluntary work by Leavesden Hospital History Association and Friends of Leavesden Country Park □
  - Paint lamp posts and directional signage - biannually □
  - Sand and paint benches and totem pole - biannually □ □
  - Inspect, clean and maintain street furniture □ □
  - Maintain natural perimeter to park for wildlife □ □
  - Maintain 0.5m long grass around all trees □ □
  - Inspect, clean and maintain all signage, including interpretation panels, maps, welcome signs □ □

Scale @ A3  
1:1,800

Date  
October 2020

Rev  
00

**THREE RIVERS  
DISTRICT COUNCIL**

© Crown copyright and database rights 2020 OS EUL 100019606. Use of this data is subject to terms and conditions. You are permitted to use this data solely to enable you to respond to, or interact with, the organisation that provided you with the data. You are not permitted to copy, sub-licence, distribute or sell any of this data to third parties in any form.

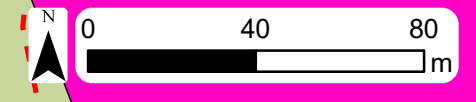

# Leavesden Country Park Management and Maintenance Plan The Horses' Field

- Task responsibility**
- TRDC Environmental Protection
  - TRDC Landscape & Leisure
  - TRDC Other
  - Volunteers
  - HCC/CMS

- Legend**
- Site boundary
  - Amenity grass
  - Conservation grassland
  - Hard surfaced path
  - Hedgerow
  - Mown grass path
  - Ornamental beds
  - Play area
  - Scrub
  - Wildflower area
  - Woodland
  - Bench
  - Dog bin
  - Entrance sign
  - Finger post
  - Interpretation sign
  - Kissing gate
  - Litter bin
  - Picnic table
  - Vehicle entrance
  - Sculptures
  - Parkland tree
  - Underground Power Line

Mow paths through field - monthly Apr-Sep

Conservation grazing of grassland - Jun-Sep

Weed hedge twice annually

Langley Lane

South Way

Weed hedge twice annually

Langley Lane play area:  
Weekly visual inspection  
Monthly routine inspection  
Annual inspection

- Site wide works**
- Tree safety survey every 2-3 years, with annual check
  - General tree safety management
  - Check and reduce epicormic growth - twice annually
  - Voluntary work by Leavesden Hospital History Association and Friends of Leavesden Country Park
  - Paint lamp posts and directional signage - biannually
  - Sand and paint benches and totem pole - biannually
  - Inspect, clean and maintain street furniture
  - Maintain natural perimeter to park for wildlife
  - Maintain 0.5m long grass around all trees
  - Inspect, clean and maintain all signage, including interpretation panels, maps, welcome signs

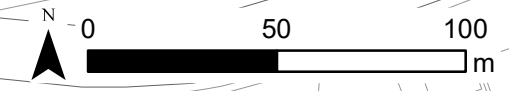

Scale @ A3  
1:2,000

Date  
October 2020

Rev  
00

© Crown copyright and database rights 2020 OS EUL 100019606. Use of this data is subject to terms and conditions. You are permitted to use this data solely to enable you to respond to, or interact with, the organisation that provided you with the data. You are not permitted to copy, sub-licence, distribute or sell any of this data to third parties in any form.



# Leavesden Country Park Management and Maintenance Plan 10 Year Capital Plan

- Task responsibility**
- TRDC Environmental Protection
  - TRDC Landscape & Leisure
  - TRDC Other
  - Volunteers
  - HCC/CMS

- Legend**
- Site boundary
  - Amenity grass
  - Building
  - Car park
  - Conservation grassland
  - HIVE
  - Hard surfaced path
  - Hedgerow
  - Mown grass path
  - Orchard
  - Ornamental beds
  - Play area
  - Rough grassland
  - Scrub
  - Sensory garden
  - Sports facility
  - Wildflower area
  - Woodland
  - Bench
  - Cycle rack
  - Dog bin
  - Entrance sign
  - Finger post
  - Historical feature
  - Interpretation sign
  - Kissing gate
  - Litter bin
  - Notice board
  - Picnic table
  - Vehicle entrance
  - Sculptures
  - Parkland tree
  - Underground Power Line

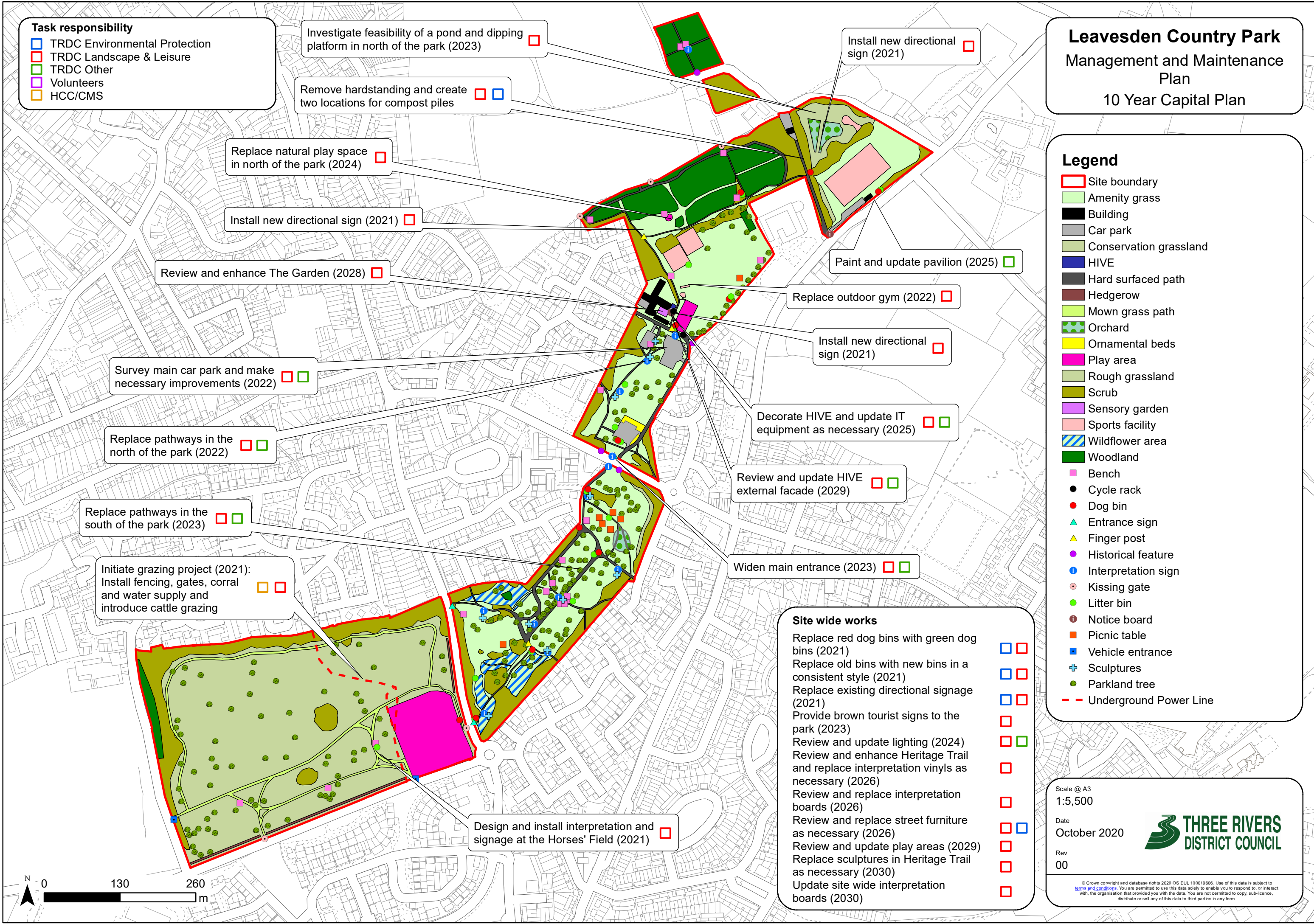

Investigate feasibility of a pond and dipping platform in north of the park (2023)

Remove hardstanding and create two locations for compost piles

Install new directional sign (2021)

Replace natural play space in north of the park (2024)

Install new directional sign (2021)

Paint and update pavilion (2025)

Review and enhance The Garden (2028)

Replace outdoor gym (2022)

Survey main car park and make necessary improvements (2022)

Install new directional sign (2021)

Decorate HIVE and update IT equipment as necessary (2025)

Replace pathways in the north of the park (2022)

Review and update HIVE external facade (2029)

Replace pathways in the south of the park (2023)

Widen main entrance (2023)

Initiate grazing project (2021):  
Install fencing, gates, corral and water supply and introduce cattle grazing

- Site wide works**
- Replace red dog bins with green dog bins (2021)
  - Replace old bins with new bins in a consistent style (2021)
  - Replace existing directional signage (2021)
  - Provide brown tourist signs to the park (2023)
  - Review and update lighting (2024)
  - Review and enhance Heritage Trail and replace interpretation vinyls as necessary (2026)
  - Review and replace interpretation boards (2026)
  - Review and replace street furniture as necessary (2026)
  - Review and update play areas (2029)
  - Replace sculptures in Heritage Trail as necessary (2030)
  - Update site wide interpretation boards (2030)

Design and install interpretation and signage at the Horses' Field (2021)

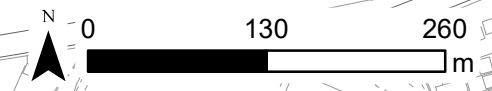

Scale @ A3  
1:5,500

Date  
October 2020

Rev  
00



© Crown copyright and database rights 2020 OS EUL 100019606. Use of this data is subject to terms and conditions. You are permitted to use this data solely to enable you to respond to, or interact with, the organisation that provided you with the data. You are not permitted to copy, sub-licence, distribute or sell any of this data to third parties in any form.