

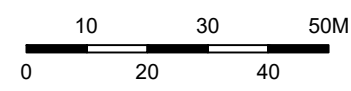

GENERAL NOTES:

1. ALL DIMENSIONS TO BE VERIFIED ON SITE AND ANY DISCREPANCIES REPORTED BACK TO RDT ARCHITECTS.
2. COPYRIGHT OF THIS DRAWING IS RESERVED BY RDT ARCHITECTS.
3. THIS DRAWING IS FOR PLANNING PURPOSES ONLY.

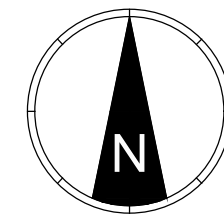

KEY	
—	SITE APPLICATION BOUNDARY
—	ADJOINING LAND WITHIN APPLICANT OWNERSHIP

PL2	BOUNDARY LINES UPDATED	SJT	01.03.21
PL1	PLANNING ISSUE	CMY	11.12.20
REV	DESCRIPTION	BY	DATE

PROJECT WORK STAGE
PLANNING

CLIENT
HERTFORDSHIRE COUNTY COUNCIL

PROJECT
FORMER LITTLE FURZE PRIMARY SCHOOL, GOSFORTH LANE, SOUTH OXHEY, WD19 7RE

DRWG TITLE
SITE LOCATION PLAN

PROJECT	ORIGINATOR	ZONE	LEVEL	TYPE	DIS	NUMBER
1276PL	RDT	ZZ	XX	DR	A	0001

STATUS SUITABILITY DESCRIPTION
-

DRAWN BY	DATE	SCALE	CHECKED BY
SJT	OCT 20	1:1250	CC

RDT PROJECT REF.	PAPER SIZE	REVISION
1276	A3	PL2



1 Harrier Court, Woodside Road
Lower Woodside, Bedfordshire LU1 4DQ
T: +44(0)1582 461060
E: rdt@rdtarchitects.co.uk
www.rdtarchitects.co.uk

SITE LOCATION PLAN



- GENERAL NOTES:**
1. ALL DIMENSIONS TO BE VERIFIED ON SITE AND ANY DISCREPANCIES REPORTED BACK TO RDT ARCHITECTS.
 2. COPYRIGHT OF THIS DRAWING IS RESERVED BY RDT ARCHITECTS.
 3. THIS DRAWING IS FOR PLANNING PURPOSES ONLY.

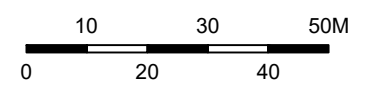
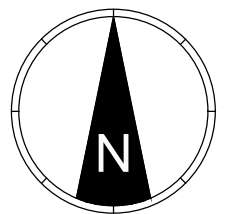

KEY	
—	SITE APPLICATION BOUNDARY
—	ADJOINING LAND WITHIN APPLICANT OWNERSHIP

PL2	BOUNDARY LINES UPDATED	SJT	01.03.21
PL1	PLANNING ISSUE	CMY	11.12.20
REV	DESCRIPTION	BY	DATE

PROJECT WORK STAGE
PLANNING

CLIENT
HERTFORDSHIRE COUNTY COUNCIL

PROJECT
**FORMER LITTLE FURZE
PRIMARY SCHOOL, GOSFORTH LANE,
SOUTH OXHEY, WD19 7RE**

DRWG TITLE
**SITE LOCATION PLAN
AERIAL PHOTO**

PROJECT	ORIGINATOR	ZONE	LEVEL	TYPE	DIS	NUMBER
1276PL	RDT	ZZ	XX	DR	A	0005

STATUS SUITABILITY DESCRIPTION
-

DRAWN BY	DATE	SCALE	CHECKED BY
SJT	OCT 20	1:1250	CC

RDT PROJECT REF.	PAPER SIZE	REVISION
1276	A3	PL2



A R C H I T E C T S
1 Harrier Court, Woodside Road
Lower Woodside, Bedfordshire LU1 4DQ
T: +44(0)1582 461060
E: rdt@rdtarchitects.co.uk
www.rdtarchitects.co.uk

SITE LOCATION PLAN - AERIAL PHOTOS

ROOM USE SCHEDULE

- BACK OF HOUSE
- BEDROOMS
- ENTRANCE PLAZA
- HORIZONTAL CIRCULATION
- LIVING & DINING
- RESIDENTS ANCILLARY ACOMM
- STAFF MANAGEMENT
- VERTICAL CIRCULATION

GENERAL NOTES
 1. ALL DIMENSIONS TO BE VERIFIED IN SITE AND ANY DISCREPANCIES REPORTED BACK TO RDT ARCHITECTS.
 2. COPYRIGHT OF THIS DRAWING IS RESERVED BY RDT ARCHITECTS
 3. THIS DRAWING IS FOR PLANNING PURPOSES ONLY

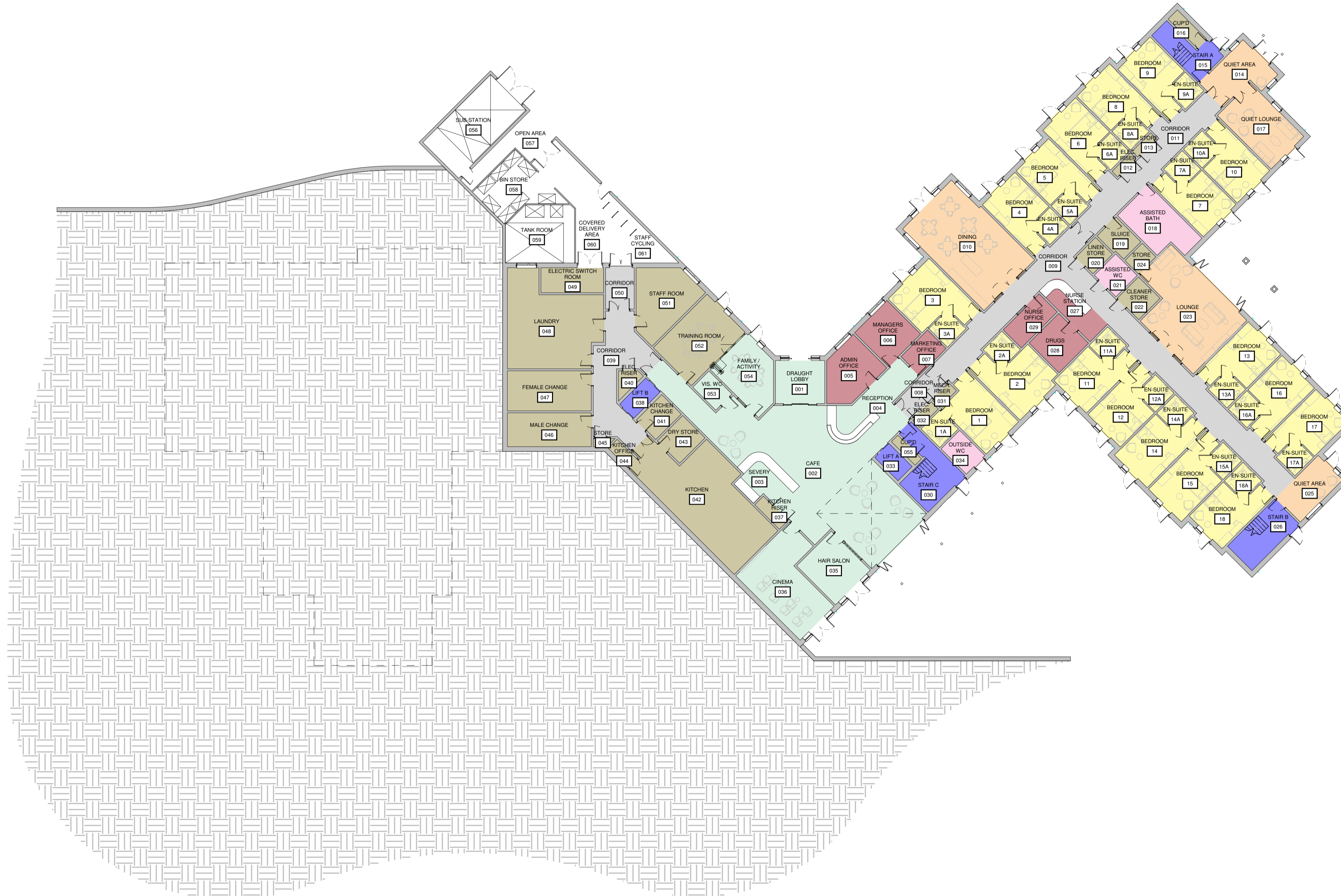
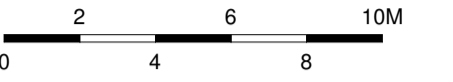
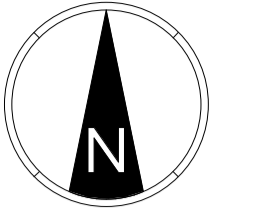

PL1	PLANNING ISSUE	CMY	11.12.20
REV	DESCRIPTION	BY	DATE
PROJECT WORK STAGE			
PLANNING			
CLIENT			
HERTFORDSHIRE COUNTY COUNCIL			
PROJECT			
FORMER LITTLE FURZE PRIMARY SCHOOL, GOSFORTH LANE, SOUTH OXHEY, WD19 7RE			
DRWG TITLE			
GROUND FLOOR GENERAL ARRANGEMENT COLOURED			
PROJECT	ORIGINATOR	ZONE	LEVEL
1276PL	RDT	ZZ	00
TYPE	DIS	NUMBER	
DR	A	2105	
STATUS SUITABILITY DESCRIPTION			
DRAWN BY	DATE	SCALE	CHECKED BY
CML	OCT 20	1 : 200	CC
RDT PROJECT REF.	PAPER SIZE	REVISION	
1276	A1	PL1	



GROUND FLOOR - GENERAL ARRANGEMENT - COLOURED

1 Harrier Court, Woodside Road
 Lower Woodside, Bedfordshire LU1 4DQ
 T: +44(0)1582 461060
 E: rdt@rdtarchitects.co.uk
 www.rdtarchitects.co.uk

ROOM USE SCHEDULE

- BACK OF HOUSE
- BEDROOMS
- HORIZONTAL CIRCULATION
- LIVING & DINING
- RESIDENTS ANCILLARY ACOMM
- STAFF MANAGEMENT
- VERTICAL CIRCULATION

GENERAL NOTES
 1. ALL DIMENSIONS TO BE VERIFIED IN SITE AND ANY DISCREPANCIES REPORTED BACK TO RDT ARCHITECTS.
 2. COPYRIGHT OF THIS DRAWING IS RESERVED BY RDT ARCHITECTS
 3. THIS DRAWING IS FOR PLANNING PURPOSES ONLY

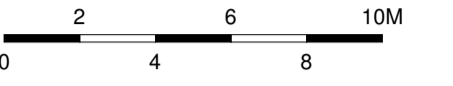
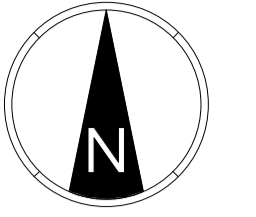

PL1	PLANNING ISSUE	CMY	11.12.20
REV	DESCRIPTION	BY	DATE

PLANNING

CLIENT
HERTFORDSHIRE COUNTY COUNCIL

PROJECT
FORMER LITTLE FURZE PRIMARY SCHOOL, GOSFORTH LANE, SOUTH OXHEY, WD19 7RE

FIRST FLOOR GENERAL ARRANGEMENT COLOURED

PROJECT	ORIGINATOR	ZONE	LEVEL	TYPE	DIS	NUMBER
1276PL	RDT	ZZ	01	DR	A	2205

STATUS: SUITABILITY DESCRIPTION

DRAWN BY	DATE	SCALE	CHECKED BY
CML	OCT 20	1 : 200	CC
RDT PROJECT REF.	PAPER SIZE	REVISION	
1276	A1	PL1	



1 Harrier Court, Woodside Road
 Lower Woodside, Bedfordshire LU1 4DQ
 T: +44(0)1582 461060
 E: rdt@rdtarchitects.co.uk
 www.rdtarchitects.co.uk

FIRST FLOOR - GENERAL ARRANGEMENT - COLOURED

ROOM USE SCHEDULE

- BACK OF HOUSE
- BEDROOMS
- HORIZONTAL CIRCULATION
- LIVING & DINING
- RESIDENTS ANCILLARY ACOMM
- STAFF MANAGEMENT
- VERTICAL CIRCULATION

GENERAL NOTES
 1. ALL DIMENSIONS TO BE VERIFIED IN SITE AND ANY DISCREPANCIES REPORTED BACK TO RDT ARCHITECTS.
 2. COPYRIGHT OF THIS DRAWING IS RESERVED BY RDT ARCHITECTS
 3. THIS DRAWING IS FOR PLANNING PURPOSES ONLY

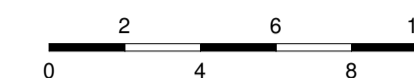
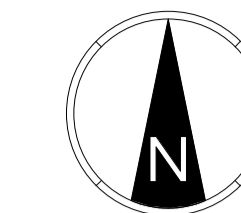

NOTE: EXTENT OF PV PANELS TO BE CONFIRMED BY CPW

PL1	PLANNING ISSUE	CMY	11.12.20
REV	DESCRIPTION	BY	DATE

PROJECT WORK STAGE
PLANNING

CLIENT
 HERTFORDSHIRE COUNTY COUNCIL

PROJECT
 FORMER LITTLE FURZE PRIMARY SCHOOL, GOSFORTH LANE, SOUTH OXHEY, WD19 7RE

DRWG TITLE
 SECOND FLOOR GENERAL ARRANGEMENT COLOURED

PROJECT	ORIGINATOR	ZONE	LEVEL	TYPE	DIS	NUMBER
1276PL	RDT	ZZ	02	DR	A	2305

STATUS | SUITABILITY DESCRIPTION

DRAWN BY	DATE	SCALE	CHECKED BY
CML	OCT 20	1 : 200	CC
RDT PROJECT REF.	PAPER SIZE	REVISION	
1276	A1	PL1	



SECOND FLOOR - GENERAL ARRANGEMENT - COLOURED

1 Harrier Court, Woodside Road
 Lower Woodside, Bedfordshire LU1 4DQ
 T: +44(0)1582 461060
 E: rdt@rdtarchitects.co.uk
 www.rdtarchitects.co.uk

GENERAL NOTES
 1. ALL DIMENSIONS TO BE VERIFIED IN SITE AND ANY DISCREPANCIES REPORTED BACK TO RDT ARCHITECTS.
 2. COPYRIGHT OF THIS DRAWING IS RESERVED BY RDT ARCHITECTS
 3. THIS DRAWING IS FOR PLANNING PURPOSES ONLY

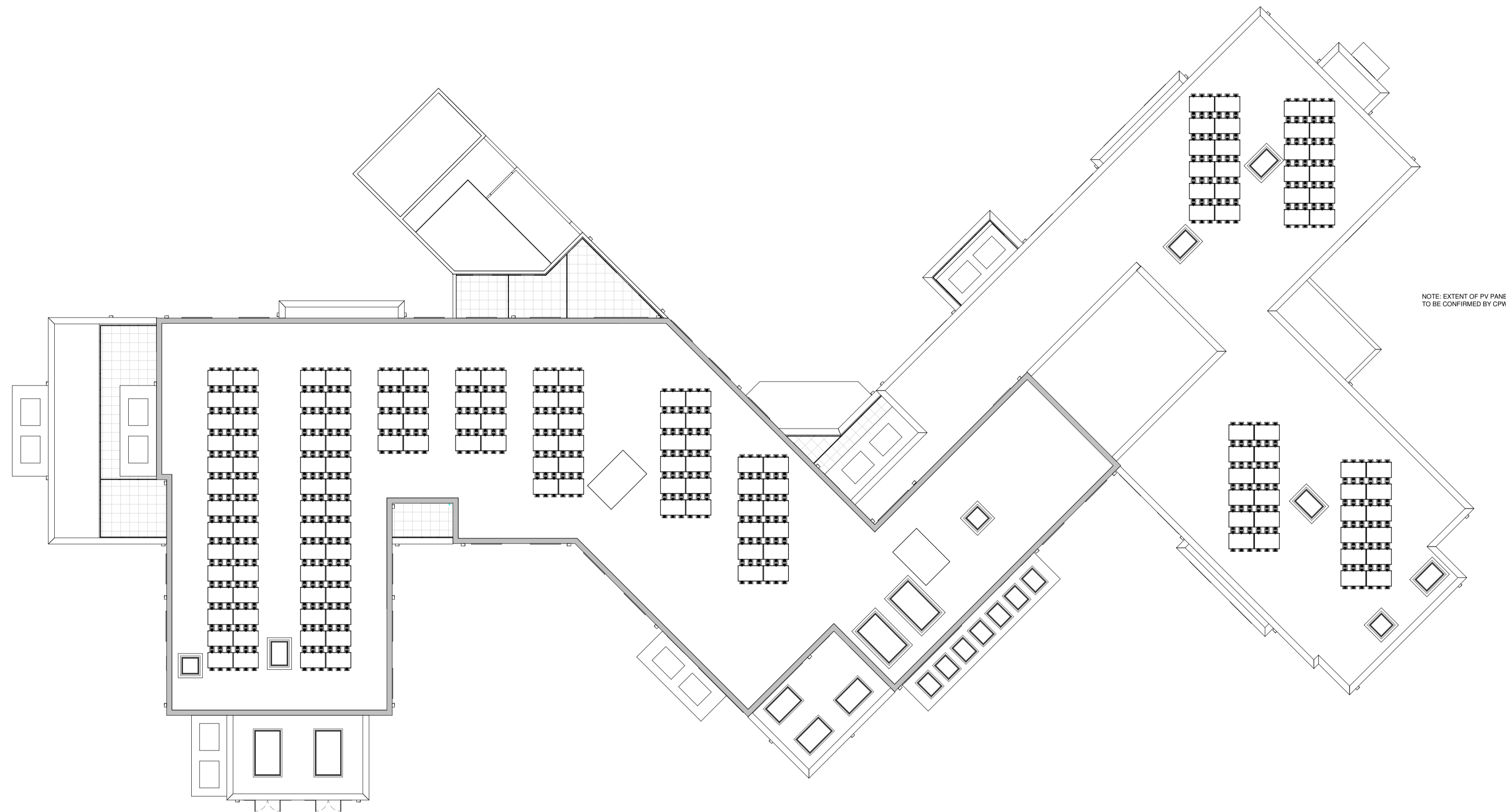
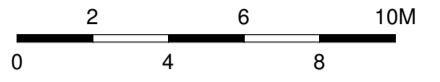
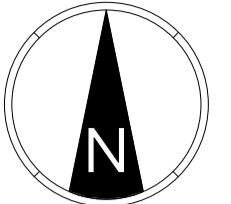

PL1	PLANNING ISSUE	CMY	11.12.20
REV	DESCRIPTION	BY	DATE

PROJECT WORK STAGE
PLANNING

CLIENT
 HERTFORDSHIRE COUNTY COUNCIL

PROJECT
 FORMER LITTLE FURZE PRIMARY SCHOOL, GOSFORTH LANE, SOUTH OXHEY, WD19 7RE

DRWG TITLE
 ROOF
 GENERAL ARRANGEMENT

PROJECT	ORIGINATOR	ZONE	LEVEL	TYPE	DIS	NUMBER
1276PL	RDT	ZZ	03	DR	A	2400

STATUS | SUITABILITY DESCRIPTION

DRAWN BY	DATE	SCALE	CHECKED BY
CML	OCT 20	1 : 200	CC

RDT PROJECT REF.	PAPER SIZE	REVISION
1276	A1	PL1



1 Harrier Court, Woodside Road
 Lower Woodside, Bedfordshire LU1 4DQ
 T: +44(0)1582 461060
 E: rdt@rdtarchitects.co.uk
 www.rdtarchitects.co.uk

ROOF - GENERAL ARRANGEMENT

GENERAL NOTES
 1. ALL DIMENSIONS TO BE VERIFIED IN SITE AND ANY DISCREPANCIES REPORTED BACK TO RDT ARCHITECTS.
 2. COPYRIGHT OF THIS DRAWING IS RESERVED BY RDT ARCHITECTS
 3. THIS DRAWING IS FOR PLANNING PURPOSES ONLY

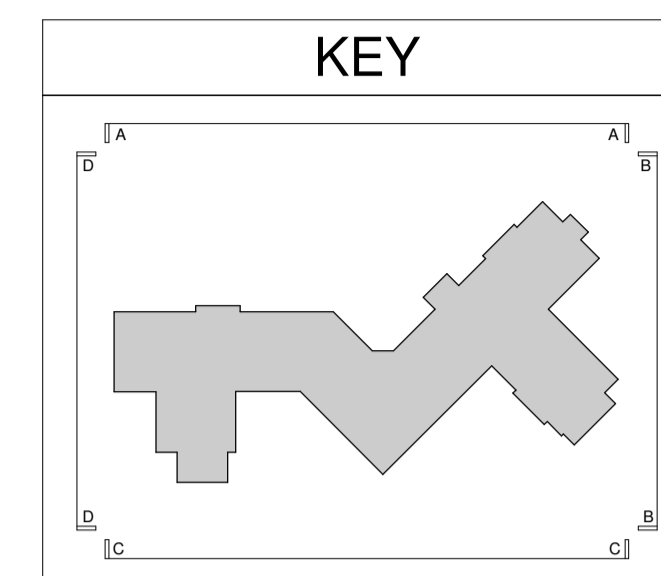
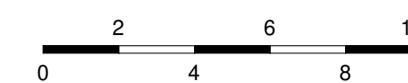

ELEVATION A-A - NORTH ELEVATION



ELEVATION B-B - EAST ELEVATION

PL1	PLANNING ISSUE	CMY	11.12.20
REV	DESCRIPTION	BY	DATE

PROJECT WORK STAGE
PLANNING

CLIENT

HERTFORDSHIRE COUNTY COUNCIL

PROJECT
 FORMER LITTLE FURZE PRIMARY SCHOOL, GOSFORTH LANE, SOUTH OXHEY, WD19 7RE

DRWG TITLE
 ILLUSTRATIVE ELEVATIONS SHEET 1

PROJECT	ORIGINATOR	ZONE	LEVEL	TYPE	DIS	NUMBER
1276PL	RDT	ZZ	ZZ	DR	A	3275

STATUS | SUITABILITY DESCRIPTION

DRAWN BY	DATE	SCALE	CHECKED BY
CMY	DEC 20	NTS	CC

RDT PROJECT REF.	PAPER SIZE	REVISION
1276	A1	PL1



ILLUSTRATIVE ELEVATIONS - SHEET 1

1 Harrier Court, Woodside Road
 Lower Woodside, Bedfordshire LU1 4DQ
 T: +44(0)1582 461060
 E: rdt@rdtarchitects.co.uk
 www.rdtarchitects.co.uk

GENERAL NOTES
 1. ALL DIMENSIONS TO BE VERIFIED IN SITE AND ANY DISCREPANCIES REPORTED BACK TO RDT ARCHITECTS.
 2. COPYRIGHT OF THIS DRAWING IS RESERVED BY RDT ARCHITECTS
 3. THIS DRAWING IS FOR PLANNING PURPOSES ONLY

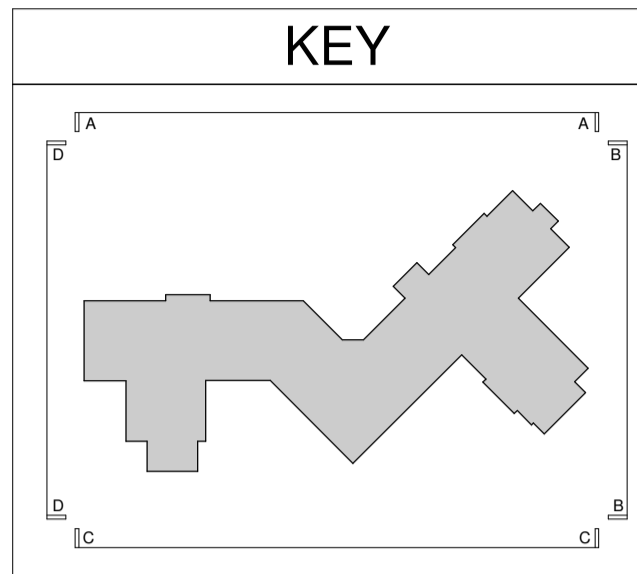

ELEVATION C-C - SOUTH ELEVATION



ELEVATION D-D - WEST ELEVATION

PL1	PLANNING ISSUE	CMY	11.12.20
REV	DESCRIPTION	BY	DATE

PROJECT WORK STAGE
PLANNING

CLIENT

HERTFORDSHIRE COUNTY COUNCIL

PROJECT

FORMER LITTLE FURZE PRIMARY SCHOOL, GOSFORTH LANE, SOUTH OXHEY, WD19 7RE

DRWG TITLE

ILLUSTRATIVE ELEVATIONS SHEET 2

PROJECT	ORIGINATOR	ZONE	LEVEL	TYPE	DIS	NUMBER
1276PL	RDT	ZZ	ZZ	DR	A	3276

STATUS | SUITABILITY DESCRIPTION

DRAWN BY	DATE	SCALE	CHECKED BY
CMY	DEC 20		CC

RDT PROJECT REF.	PAPER SIZE	REVISION
1276	A1	PL1



ILLUSTRATIVE ELEVATIONS - SHEET 2



GENERAL NOTES:
 1. ALL DIMENSIONS TO BE VERIFIED ON SITE AND ANY DISCREPANCIES REPORTED BACK TO RDT ARCHITECTS.
 2. COPYRIGHT OF THIS DRAWING IS RESERVED BY RDT ARCHITECTS.
 3. THIS DRAWING IS FOR PLANNING PURPOSES ONLY.

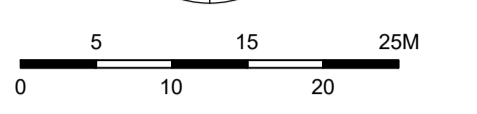
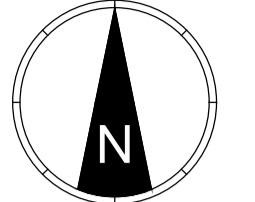

NOTE:
 1. ORIGINAL SURVEY INFORMATION TAKEN FROM TOPOGRAPHICAL SURVEY DRAWING OF 1985 PRODUCED BY SUNSHINE SURVEY LTD. REFER TO ORIGINAL SURVEY INFORMATION FOR DETAILED LEVEL INFORMATION. SITE CO-ORDINATES ARE TO OS

NOTE:
 - SITE APPLICATION BOUNDARY (Red line)
 - CARE HOME SITE BOUNDARY (Orange line)
 - 2.5 ACRES / 1.2 HECTARES (Hatched area)
 - 15m BUFFER TO ANCIENT WOODLAND (Cross-hatched area)
 - FUTURE RESIDENTIAL LAND PARCEL (Grey area)
 - SURFACE WATER ATTENUATION FEATURE (Green wavy lines)
 DRAWING TO BE READ IN CONJUNCTION WITH INGLETON WOOD SURFACE WATER DRAINAGE STRATEGY AND ADAMS HASSEMERH, LANDSCAPE PLANS

PL2	GENERAL UPDATE TO ACCESS ROAD, CARE HOME ACCESSIBLE PARKING BAY MARKINGS ADDED TO BAYS 6 AND 7	SJT	01.03.21
PL1	PLANNING ISSUE	CMY	11.12.20
REV	DESCRIPTION	BY	DATE

PROJECT WORK STAGE: **PLANNING**

CLIENT: **HERTFORDSHIRE COUNTY COUNCIL**

PROJECT: **FORMER LITTLE FURZE PRIMARY SCHOOL, GOSFORTH LANE, SOUTH OXHEY, WD19 7RE**

DRWG TITLE: **PROPOSED CONTEXTUAL SITE PLAN COLOURED**

PROJECT	ORIGINATOR	ZONE	LEVEL	TYPE	DIS	NUMBER
1276PL	RDT	ZZ	XX	DR	A	1050

STATUS: SUITABILITY DESCRIPTION

DRAWN BY	DATE	SCALE	CHECKED BY
SJT	OCT 20	1:500	CC
RDT PROJECT REF.	PAPER SIZE	REVISION	
1276	A1	PL2	



PROPOSED CONTEXTUAL SITE PLAN - COLOURED

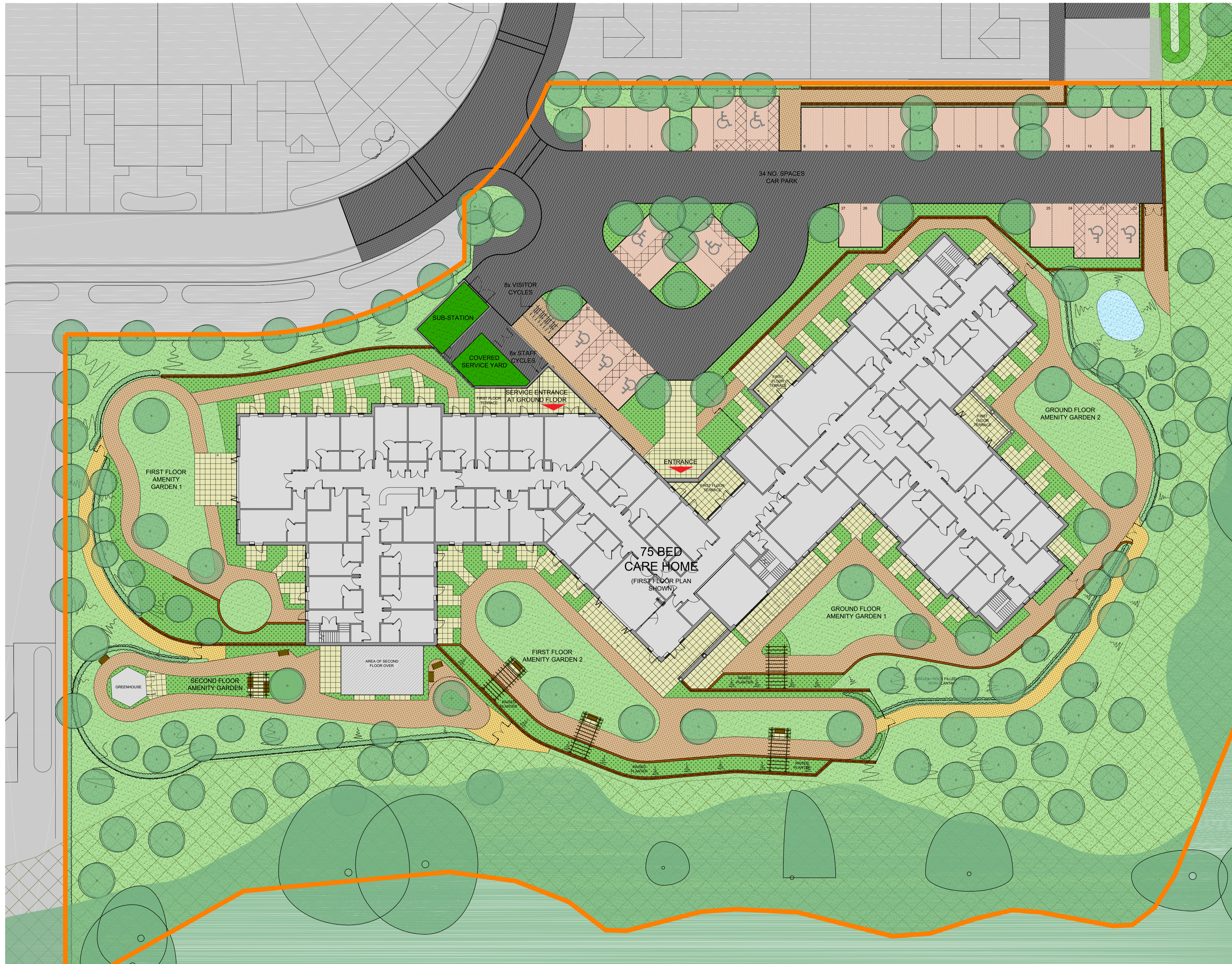

GENERAL NOTES:
 1. ALL DIMENSIONS TO BE VERIFIED ON SITE AND ANY DISCREPANCIES REPORTED BACK TO RDT ARCHITECTS.
 2. COPYRIGHT OF THIS DRAWING IS RESERVED BY RDT ARCHITECTS.
 3. THIS DRAWING IS FOR PLANNING PURPOSES ONLY.

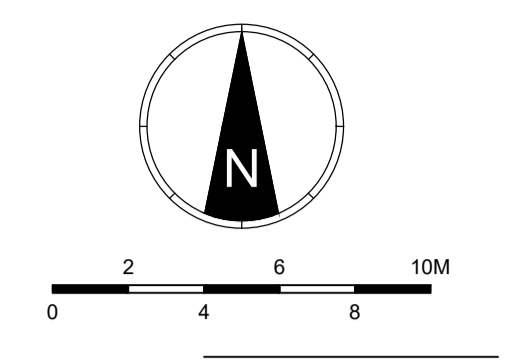

1. ORIGINAL SURVEY INFORMATION TAKEN FROM TOPOGRAPHICAL SURVEY DRAWING GY3983 PRODUCED BY SUNSHINE SURVEY LTD. REFER TO ORIGINAL SURVEY INFORMATION FOR DETAILED LEVEL INFORMATION. SITE CO-ORDINATES ARE TO OS

	CARE HOME SITE BOUNDARY 2.9 ACRES / 1.2 HECTARES
	FUTURE RESIDENTIAL LAND PARCEL
	15m BUFFER TO ANCIENT WOODLAND
	ROAD
	FOOTPATH - TYPE 1
	FOOTPATH - TYPE 2
	FOOTPATH - TYPE 3
	PAVING SLABS
	BLOCK PAVING
	LAWN
	PLANTING
	GREEN ROOF
	LAND GRADING
	ATTENUATION DRAINAGE FEATURE
	RETAINING WALL
	CONTROLLED ACCESS POINT
	PERGOLA
	BENCH

PL2	GENERAL UPDATE TO ACCESS ROAD, CARE HOME ACCESSIBLE PARKING BAY MARKINGS ADDED TO BAYS 6 AND 7	SJT	01.03.21
PL1	PLANNING ISSUE	CMY	11.12.20
REV	DESCRIPTION	BY	DATE

PLANNING

CLIENT
 HERTFORDSHIRE COUNTY COUNCIL

PROJECT
 FORMER LITTLE FURZE PRIMARY SCHOOL, GOSFORTH LANE, SOUTH OXHEY, WD19 7RE

DRWG TITLE
 PROPOSED SITE PLAN COLOURED

PROJECT	ORIGINATOR	ZONE	LEVEL	TYPE	DIS	NUMBER
1276PL	RDT	ZZ	XX	DR	A	1100

STATUS | SUITABILITY DESCRIPTION

DRAWN BY	DATE	SCALE	CHECKED BY
SJT	OCT 20	1:200	CC
RDT PROJECT REF.	PAPER SIZE	REVISION	
1276	A1	PL2	



1 Harrier Court, Woodside Road
 Lower Woodside, Bedfordshire LU1 4DQ
 T: +44(0)1582 461060
 E: rdt@rdtarchitects.co.uk
 www.rdtarchitects.co.uk

PROPOSED SITE PLAN - COLOURED